

NAK STANDARD

WP14

APPLICATION : WIPER
 MATERIAL : NBR / FKM
 UNIT: METRIC

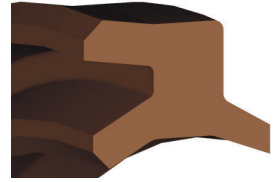

E4

Shaft diam.	Bore diam.	Width diam	Drawing no.
3	7	3/4	U00243
3.5	8.5	3.8/5	U8435
5	10	4/4.8	U1682
6	10	3/4.4	U5694
8	12	3.5/4.9	U6416
9	17	4.8/6	U2093
10	14	3.5/5	U6017
10	14.5	2.5/3	U6632
10	16	5/6.5	U8278
10	18	5/7	U2752
10.5	16	4.2/5.8	U5206
12	16	3.5/4.7	U7133
12	17	4.2/6	U5734
12	18	4/6	U3896
12	18	5/7	U2751
12.5	20	4/6	U7097
13	20	5/6.5	U7341
13	20	5/7	U0484
13	20	5.2/6.7	U5117
14	18	3.5/4.8	U5625
14	20	4/6	U3895
14	22	4.5/6	U1914
16	24	4.5/6	U1925
16	24	4.5/6	U1925
16	24	5.5/7.5	U5736
18	24	4/6	U3894
18	26	4.5/6	22275
20	28	4.5/6	22604

Shaft diam.	Bore diam.	Width diam	Drawing no.
20	28	5.5/7.5	U5996
20	30	6.5/9.5	U6639
22	28	4/6	U3893
22	28	5.3/6.3	U5598
22	30	4.5/6	U1915
22.4	30.4	4.5/6	U2041
25	31	5.7/7	U5807
25	33	4.5/6	22605
25	33	4.5/6	22605
25	33	5.5/7.5	U6236
25	35	4.5/6.5	U5599
27.3	35	3.5/5	22700
28	36	4.5/6	U1800
28	36	5/7	U3892
30	38	4.5/6	U1396
30	38	5/6.5	U3545
30	38	5/6.5	U3545
30	40	6.5/8.2	U5624
31	40	4.5/6.4	U7051
31	44.5	5/9	U9472
32	40	5/6.5	U4772
32	42	6.5/8.5	U6724
32	44	5/9	
34	43	4.5/6.2	U7053
35	43	3.5/5	U7736
35	43	5/6.5	U1397
35	45	6.5/8.5	U6688
35.5	43.5	5/6.5	U8123

NAK STANDARD

WP14

APPLICATION : WIPER
 MATERIAL : NBR/FKM
 UNIT: METRIC



Shaft diam.	Bore diam.	Width diam	Drawing no.
36	44	5/7	U3891
36.5	47	6.5/8.5	U7236
38	46	4/5.5	U2016
40	48	5/6.5	U1398
44	51.8	5.2/8	U7823
45	53	5/6.5	U1799
45	53	5/7	U3890
45	55	6.5/8.5	U6630
50	58	5/6.5	U1399
55	63	5/6.5	U1916
56	64	5/6.5	U8330
56	66	6/8	U3889
60	68	5/6.5	U0947
65	73	5/6.5	U1917
70	80	6/8	U1400
75	85	6/8	U1918
80	90	6/8	U1919
85	95	6/8	U1920
90	100	6/8	U1921
95	105	6/8	U1922
100	110	6/8	U1923
105	115	6/8	U1924
110	120	6/8	U1926
110	125	8.5/10.5	U3888
140	155	8.5/10.5	U3886

Shaft diam.	Bore diam.	Width diam	Drawing no.

E4