



136 SERIES DRF



Easy connection to check the pressure of the hydraulic systems in different parts of the circuit.

• Materials

Carbon Steel *EN -10277-3 /AISI 316L/ Brass*

O-ring: **NBR, Viton or EPDM**

Back-up-ring: **PTFE**

Balls: *AISI 1010/1015*

Springs: *Carbon Steel DIN 17233/84(B)*

• **Applications:** Designed for Oil hydraulic. Quick-release coupling for diagnosis.

• No air inclusion within the circuit.

• Equivalence

Design according to ISO 15171-1 & SAE J1502

• Working temperature (O-ring)

	NBR	Viton	EPDM
+	+100°C	+200°C	+150°C
-	-30°C	-10°C	-40°C

• **Sectors:** Industrial. Building machinery.



MODEL STRUCTURE

Example:

136.12110BB

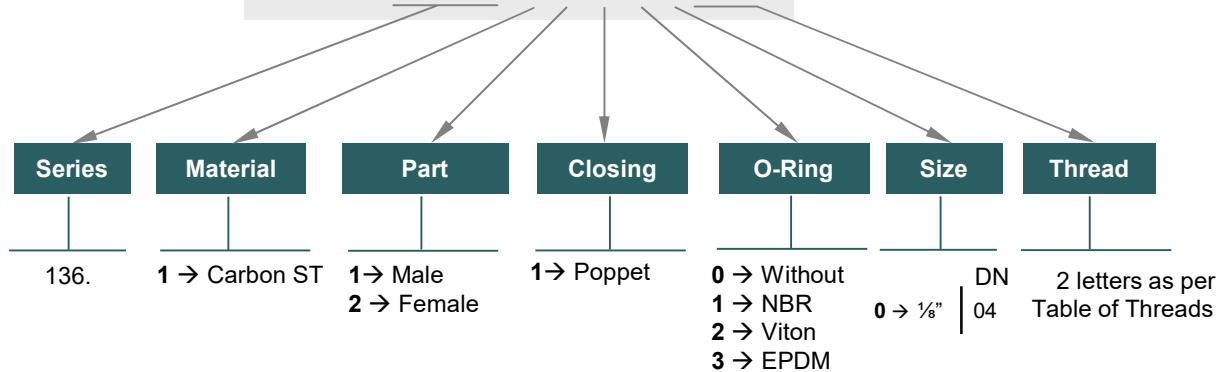

136-1





136 SERIES DRF

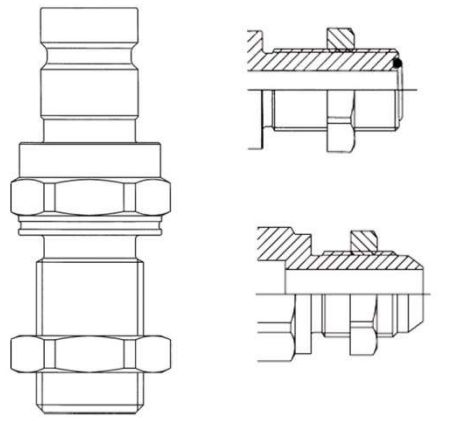
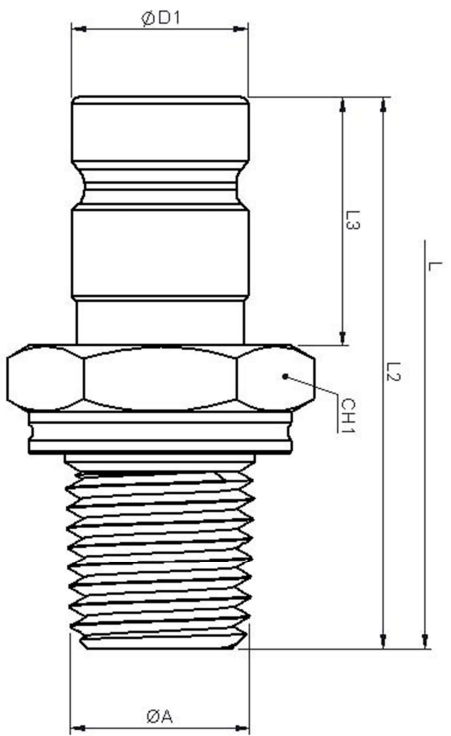

STANDARD MODELS

DN	ØA	STANDARD	REF.		L	L2	L3	CH1	ØD1
	1/8" NPTF	ANSI B1.20.3	136.11110BL						
	1/4" NPTF		136.11110BM						
	M14x1,5	ISO 6149-2	136.11110OF						
	3/8" UNF	SAE J1926-2	136.11110HA						
	7/16" UNF		136.11110HB					19	
	1/2" UNF		136.11110HC						
	9/16" UNF		136.11110HD						
	9/16" UNF		136.11110ZD						
04	11/16" UN		ISO 8434-3	136.11110ZE	420Bar	81,25	45,75	17,75	
	13/16" UN		136.11110ZG					22	
	7/16" UNF	ISO 8434-2	136.11110YB						
	1/2" UNF		136.11110YC						
	9/16" UNF		136.11110YD						
	M12x1,5		ISO 9974-2	136.11110QE					19
	M14x1,5		136.11110QF						
	1/8" BSP	DIN 3852-2	136.11110AL						
	1/4" BSP		136.11110AM						

BULKHEADS

DN	ØA	STANDARD	REF.	L	L2	L3	CH1	ØD1
	9/16" UNF		136.11110ZDP		60,3			
	11/16" UN	ISO 8434-3	136.11110ZEP		62,8			
	13/16" UN		136.11110ZGP		77,1			
04	7/16" UNF		136.11110YBP	420Bar	58	17,75	19	12,6
	1/2" UNF	ISO 8434-2	136.11110YCP		58			
	9/16" UNF		136.11110YDP		60			

Manufactured according to ISO 15171-1, size DN04 under ISO 7241-2 specifications.



DUST CAP – 136.5450AA

136-2

INTEVA reserves the right to make modifications in its products without prior notice.
Any external or internal alteration in our products will automatically void the warranty.







136 SERIES DRF

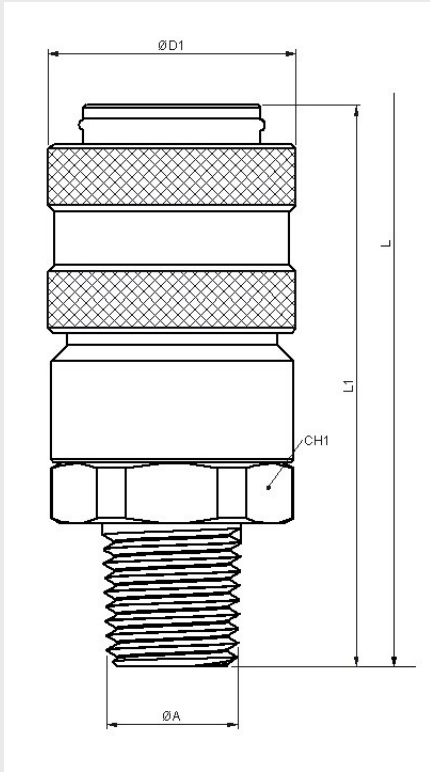

STANDARD MODELS



DN	ØA	STANDARD	REF.		L	L1	CH1	ØD1
04	1/8" NPTF	ANSI B1.20.3	136.12110BL	420Bar	81,25	55	22	24,3
	1/4" NPTF		136.12110BM					
	1/8" BSP	DIN 3852-2	136.12110AL					
	1/4" BSP		136.12110AM					



Manufactured according to ISO 15171-1, size DN04 under ISO 7241-2 specifications.

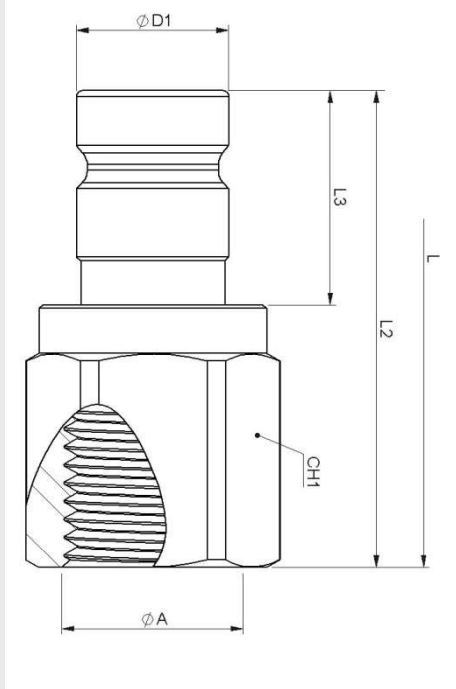

136 SERIES DRF



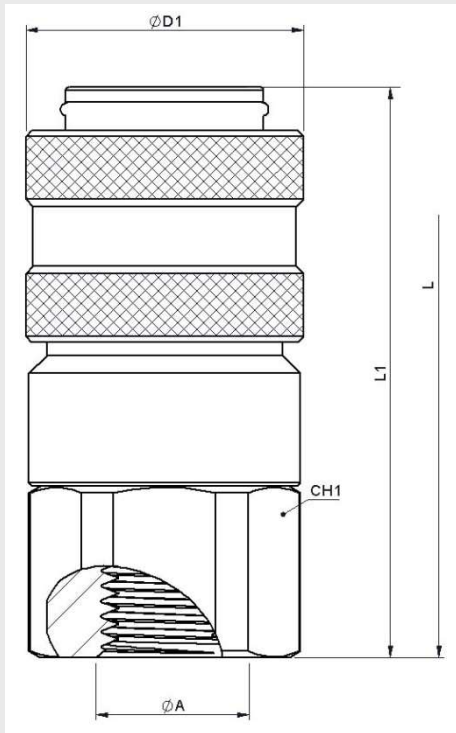

STANDARD MODELS

DN	$\varnothing A$	STANDARD	REF.		L	L2	L3	CH1	$\varnothing D1$	
04					420Bar	81,25	45,75	17,75	19	12,6



STANDARD MODELS

DN	$\varnothing A$	STANDARD	REF.		L	L1	CH1	$\varnothing D1$	
04					420Bar	81,25	54	22	24,3

Manufactured according to ISO 15171-1, size DN04 under ISO 7241-2 specifications.

136-4



136 SERIES DRF

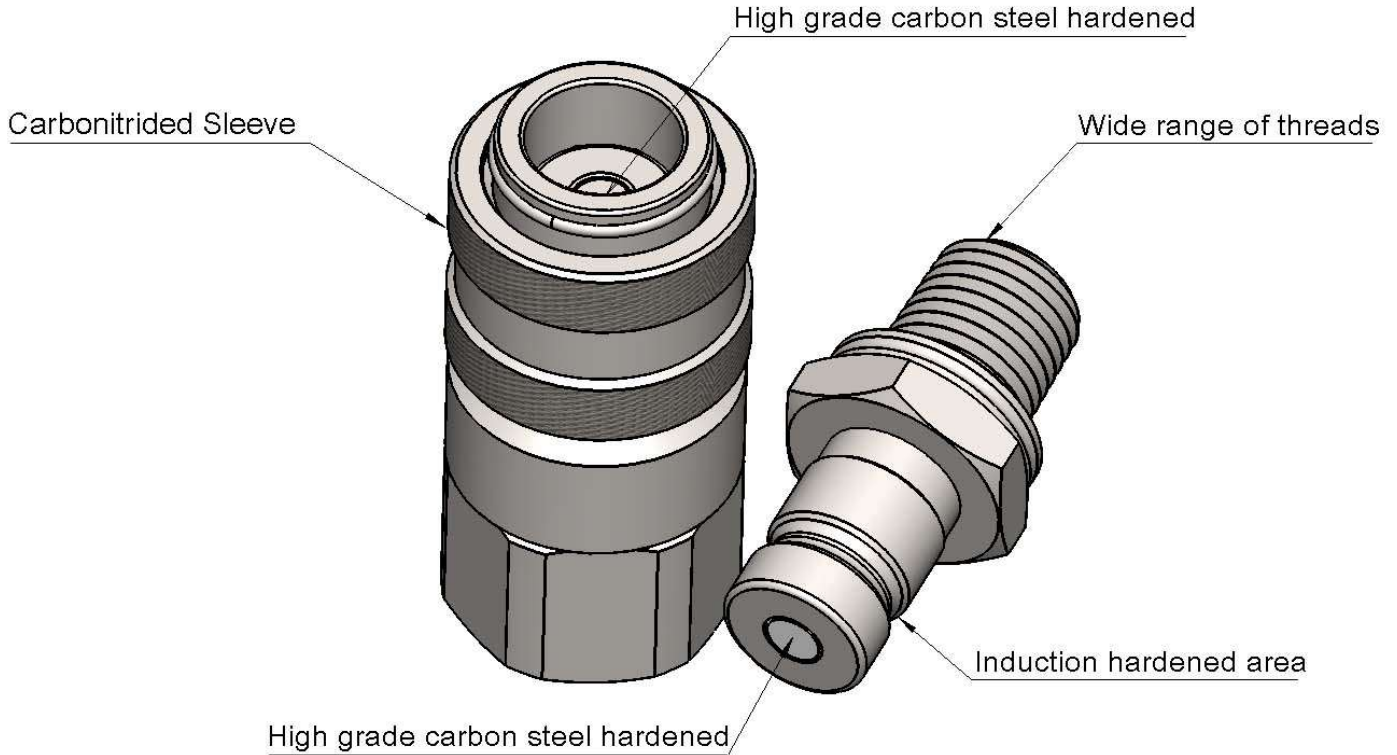

TECHNICAL DATA

Carbon Steel

DN	Max. Flow	Connection Force	Min. Burst Pressure (bar)			Max. Working Pressure	Fluid Spillage
			Male	Female	Coupled		
04	2 l/m	50N	1700	1500	1400	420Bar	Máx. 0,02

Test performed according to ISO 18869

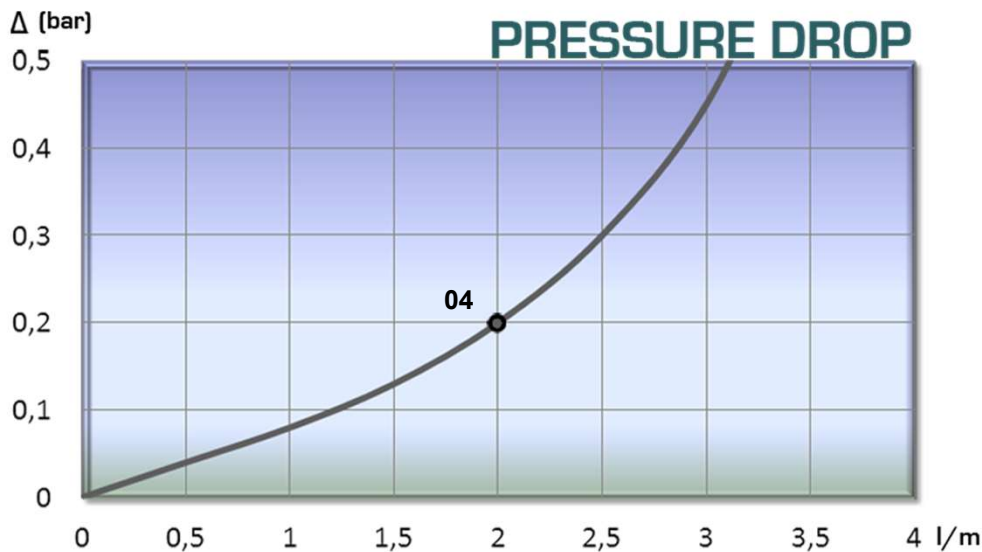

136-5

INTEVA reserves the right to make modifications in its products without prior notice. Any external or internal alteration in our products will automatically void the warranty.

