

Codice ordinazione Ordering code	01	02
	<b>VUC</b>	

<b>01</b>	Valvole unidirezionali ad otturatore (Check valves - poppet type)	<b>VUC</b>
<b>02</b>	Dimensione (Size)	BSP 1/4 <b>140</b>
		BSP 3/8 <b>380</b>

**Schema idraulico - Hydraulic circuit**



**Dati tecnici - Technical data**

<b>Olio idraulico/Mineral oil</b>	<b>ISO 6743/4 (DIN 51524)</b>	
<b>Viscosità olio/Oil viscosity</b>	<b>15-250 mm<sup>2</sup>/s (15 to 250 cSt)</b>	
<b>Classe di contaminazione max con filtro</b> Max contamination index with filter	<b>ISO 4406:1999 Classe 19/17/14</b>	
<b>Temperatura dell'olio/Oil temperature</b>	<b>-20°C +80°C</b>	<b>-4°F + 176°F</b>
<b>Temperatura ambiente/Ambient temperature</b>	<b>-20°C +50°C</b>	<b>-4°F + 122°F</b>
<b>È indispensabile l'utilizzo di un filtro per proteggere la valvola (filtrazione consigliata 15 µm)</b> It is necessary a filter use to protect the valve (advised filtration 15 µm)		
<b>Trafilamento massimo</b> Max leakage	<b>0,25 cm<sup>3</sup>/min - 5 gocce/min</b>	<b>0,015 in<sup>3</sup>/min - 5 drops/min</b>
<b>Pressione d'apertura/Opening pressure</b>	<b>0,5 bar - 7.25 PSI</b>	

**Performances**

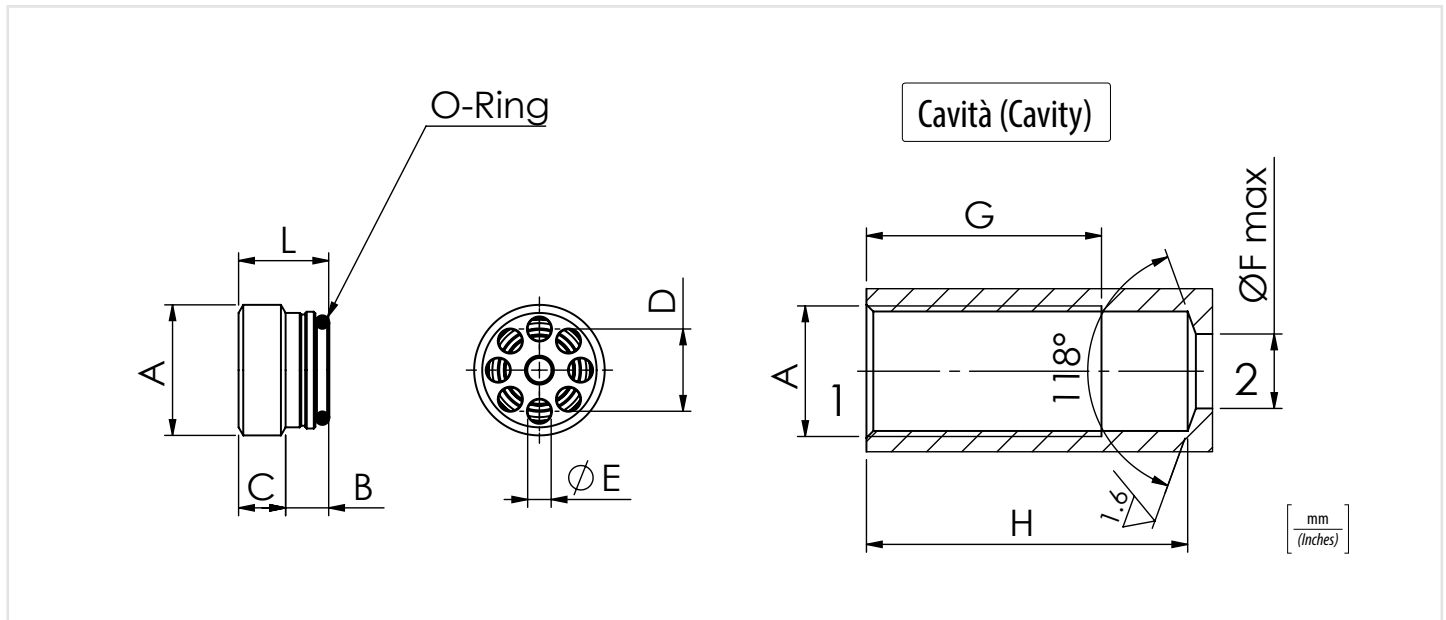
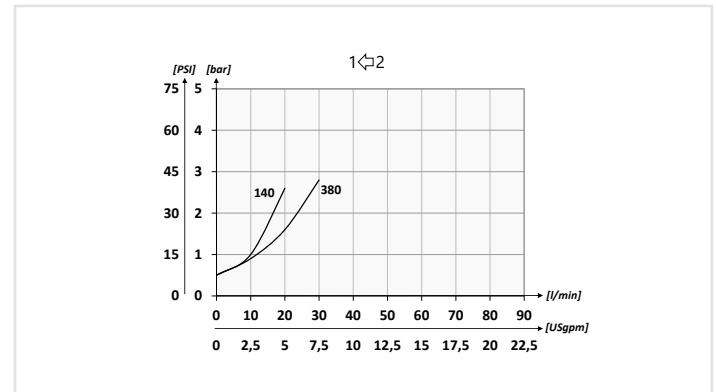

**Caratteristiche tecniche - Technical characteristics**

Tipo Type	A	Portata max Max flow l/min-USgpm	Pressione max Max pressure bar/PSI	B	C	D	E	F	G	H	L	Coppia di serraggio Tightening torque Nm/lbf ft	O-Ring	Peso approssimativo Approx weight kg/lb
<b>VUC140</b>	<b>BSP 1/4</b>	<b>20 (5.3)</b>	<b>350 (5075)</b>	<b>4 (0.16)</b>	<b>5 (0.20)</b>	<b>7 (0.28)</b>	<b>2,2 (0.94)</b>	<b>7 (0.28)</b>	<b>22 (0.87)</b>	<b>24 (0.94)</b>	<b>9 (0.35)</b>	<b>6 (53)</b>	<b>9 x 1</b>	<b>0,01 (0.022)</b>
<b>VUC380</b>	<b>BSP 3/8</b>	<b>30 (7.9)</b>		<b>5,5 (0.22)</b>	<b>6 (0.24)</b>	<b>10,5 (0.41)</b>	<b>3 (0.12)</b>	<b>9 (0.35)</b>	<b>27 (1.06)</b>	<b>29 (1.14)</b>	<b>11,5 (0.45)</b>	<b>6 (53)</b>	<b>10,82 x 1,78</b>	