



# 108 SERIES DIN-F



Manufactured according to ISO 5675 and ISO 7241 norm.  
Poppet Valve system. BSP. Others available upon request.

## • Materials

Body: Carbon Steel EN -10277-3

O-ring: NBR, Viton or EPDM

Back-Up-Ring: PTFE

Balls: AISI 1010/1015

Springs: Carbon Steel

DIN 17233/84(B)

## • Working temperature (O-ring)

	NBR	Viton	EPDM
+	+100°C	+200°C	+150°C
-	-30°C	-10°C	-40°C

• **Applications:** Designed for Oil hydraulic Applications.

• **Interchange:** H5000 EATON / 605-A GROMELLE

• **Sectors:** Industrial, Agricultural



## MODEL STRUCTURE

Example:

# 108.11115 AF

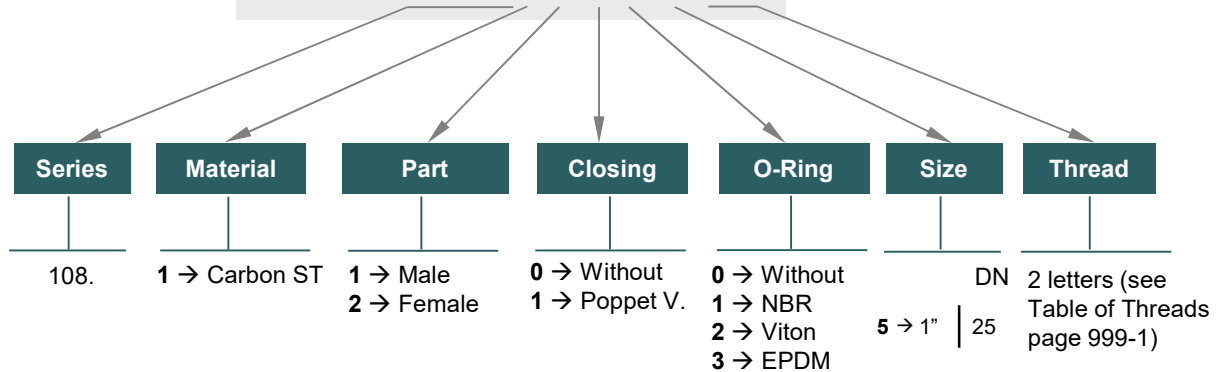

## 108-1



# 108 SERIES DIN-F



## 1" BSP DN25

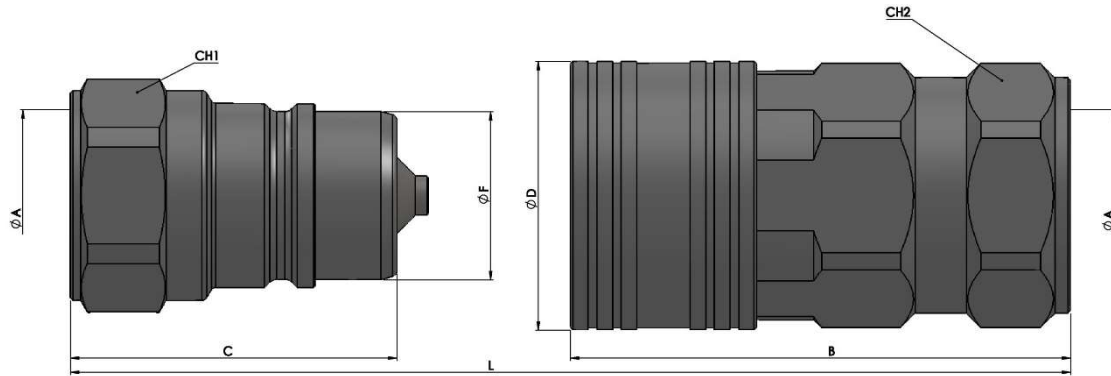

STANDARD MALE MODELS

DN	ØA	REF.		CH1	C	ØF	L
25	1" BSP	108.11115AF 300Bar		41	63	32,40	126

STANDARD FEMALE MODELS

DN	ØA	REF.		CH2	B	ØD	L
25	1" BSP	108.12115AF 300Bar		46	96,50	51,8	126



# 108 SERIES DIN-F



TECHNICAL DATA					
DN	Rated Flow	Min Burst Pressure (bar)			Max. Working Pressure
		Male	Female	Coupled	
25	100 l/m	950	980	920	300 Bar

Test performed according to ISO 18869

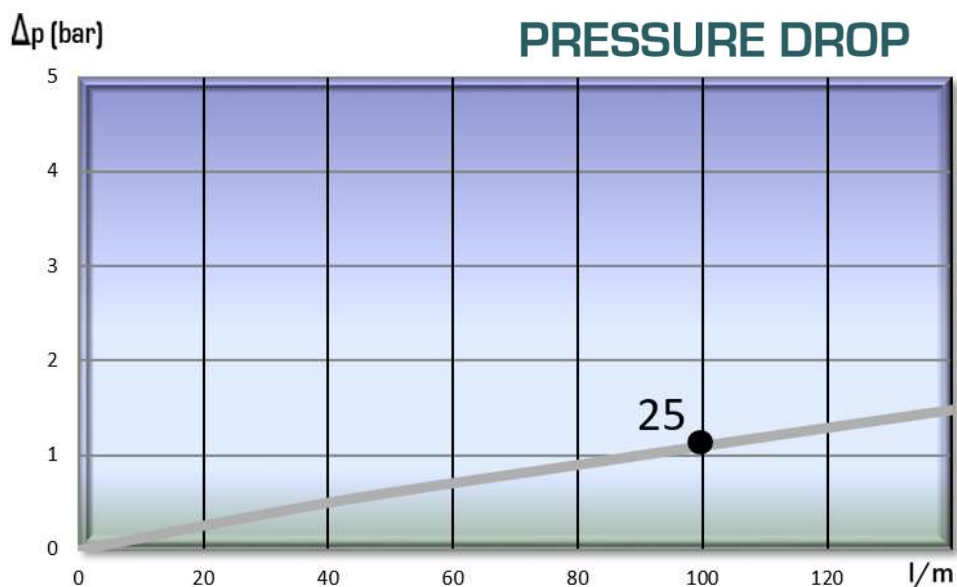

**108-3**

INTEVA reserves the right to make modifications in its products without prior notice.  
Any external or internal alteration in our products will automatically void the warranty.



v8



# 109 SERIES SMP



Poppet Valve closing system.  
BSP, NPTF, SAE/ORB threads. Other threads available upon request.

### • Materials

	CARBON STEEL	STAINLESS STEEL
Body	Carbon Steel EN-10277-3	AISI 316
O-ring	NBR, Viton or EPDM	NBR, Viton or EPDM
Back-up-ring	PTFE	PTFE
Balls	AISI 1010/1015	AISI316 W. 14401
Springs	Carbon Steel DIN 17233/84(B)	AISI302 DIN 17224

• **Applications:** Designed for Oil hydraulic Applications.

### • Equivalence

PARKER SM Series

### • Working temperature (O-ring)

	NBR	Viton	EPDM
+	+100°C	+200°C	+150°C
-	-30°C	-10°C	-40°C

### • Sectors

Carbon Steel → Industrial.

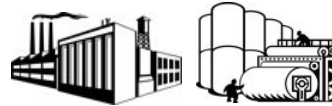

Stainless Steel → Chemical, Industrial, Offshore.



## MODEL STRUCTURE

Example:

# 109.12111 BB

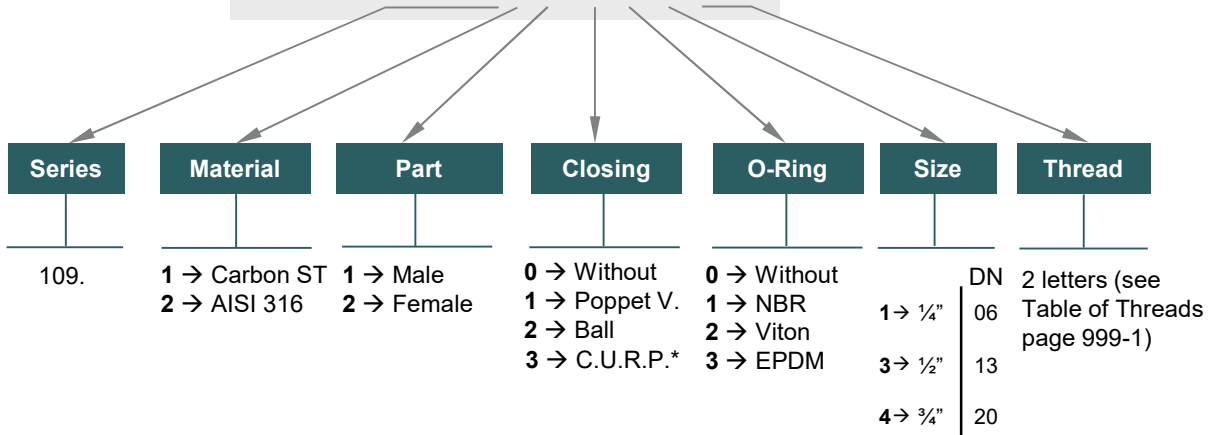

## 109-1